

Access controlled...
Future secured

DESCRIPTION

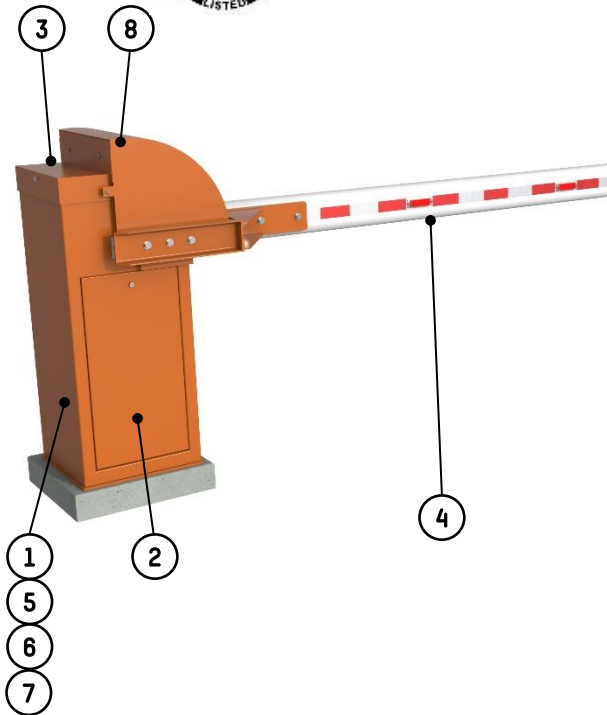

ETL LISTED No 1010090008MTL-003
ACCORDING TO UL325 AND CSA C22.2#247



Rapid rising barrier, short to medium range with **reinforced oval arm**, for installation on public roads: parking, traffic management, etc.

Configurations

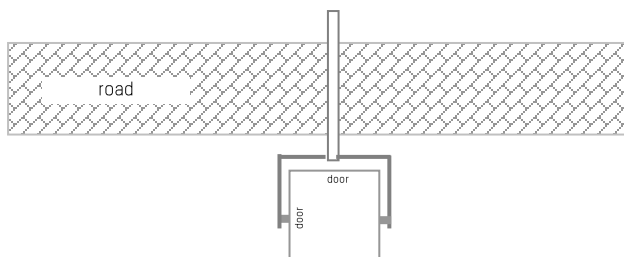

- 1. Operator cabinet** made of folded and welded sheet metal, ranging from 1/8" to 5/16" [3 to 8 mm] thick.
- 2. Removable side and front panels** with peripheral sealing joint and lock, ensuring easy access to the mechanism (see illustration).
- Weather resistant, **removable top cover** (lockable by key).
- 4. Central oval aluminium reinforced arm** measuring 6.89" x 3.93" [175 x 100 mm], white lacquered with red reflective stripes.
- 5. Solid drive shaft for the arm**, with a diameter of 2" [50 mm], mounted on 2 lubricated for life bearings.
- 6. Electromechanical assembly:**
 - Reversible three-phase asynchronous gear motor, ensuring protection of the mechanism in the event of forced lifting of the arm due to fraud.
 - Secondary transmission via gearwheel and sprocket wheel. Maintaining the arm in its two extreme positions (open and closed), as well as after a STOP command is achieved by means of an electromagnetic brake.
 - Frequency inverter ensuring progressive accelerations and controlled decelerations, for a vibration-free movement enhanced protection of the mechanism.
 - Electronic torque limitation ensures an immediate stoppage of the arm during closing (in the event of an obstacle).
 - Inductive limit switches.
 - Balancing of the arm by means of one or more compression springs, depending on the weight of the arm.
- 7. Configurable AS1620 electronic control board** allowing for various control options and/or additional accessories. Among the features of the logic:
 - IP addressable
 - Configurable relays allowing the communication of different barrier status through dry contact.
 - Master-slave command allowing the control of 2 barriers facing each other (movement of one barrier controlled by the other barrier).
- 8. Protective hood** to prevent entrapment according to UL325.

SURFACE TREATMENT

- Zinc-coated internal mechanical parts.
- Complete body (housing, cover and doors): corrosion resistant primer + powder coat paint (standard color: Orange RAL 2000)

STANDARD TECHNICAL CHARACTERISTICS

Input power ⁽¹⁾	120 VAC / 60 Hz (with ground)
Consumption	450 W (nominal) - 950 W (max. with biggest heater)
Motor	Three-phase 240 V / 250 W controlled by frequency inverter
Transmission	Reversible ring and pinion speed reducer, service factor 1.2
Arm length (L)	6.6 to 19.7 ft [2 to 6m] <i>Increments of 1.63 ft [0.5m]</i>
Operating temperature	14°F to 122°F [-10°C to 50°C]
Relative Humidity	95% without condensation
Wind resistance	74.6 mi/h [120 km/h]
Opening speed ⁽²⁾	5.5 s
Closing speed ⁽²⁾	5.5 s
Weight (without arm)	550 lbs (250 kg)
Poids de la lisse	11 à 37 kg [24,2 à 81,4 lbs]
MCBF ⁽³⁾	3,000,000 cycles <i>(with recommended maintenance)</i>

- (1) not to be connected to a floating network or to high impedance earthed industrial distribution network
 (2) adjustable through the control board
 (3) Mean Cycle Before Failure

STANDARD DIMENSIONS (INCHES & MM)

Refer to the installation drawing for more details.

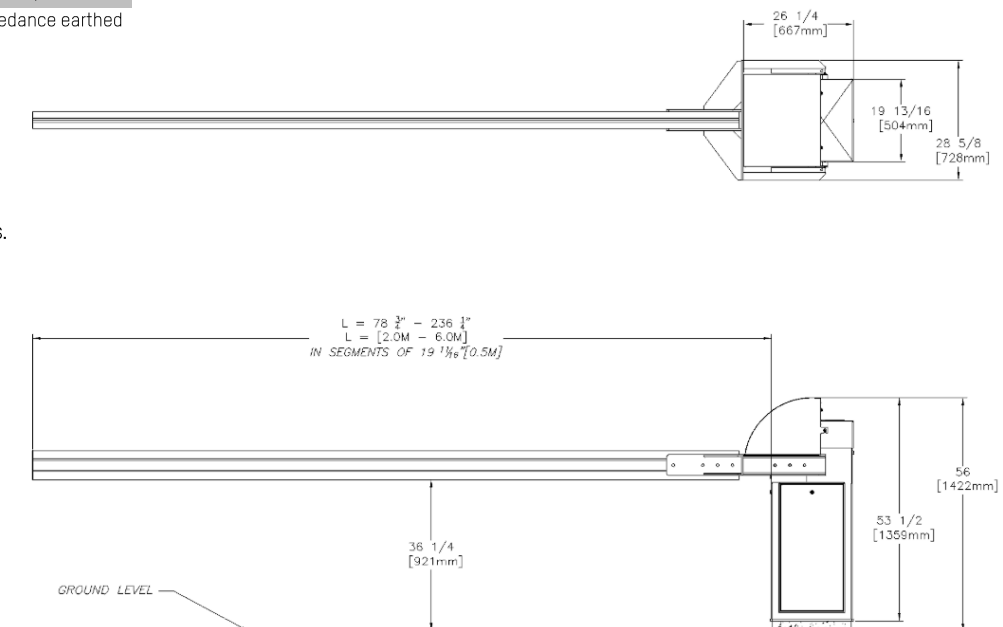
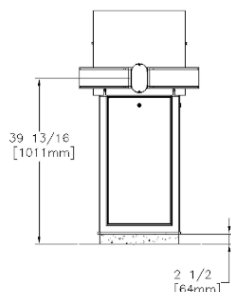

OPTIONS

1. Automatic opening of the arm during power failure ^(a).
2. Standard adjustable tip support.
3. Electromagnetic tip support.
4. Folding tip support
5. Safety edge.
6. STOP sign with a diameter of 300 mm.
7. Traffic lights on a post mounted on housing. ^(c)
8. Traffic lights mounted on a standalone post.
9. Push-button box.
10. Key switch
11. Radio transmitter/receiver.
12. Detection loop.
13. Presence detector for inductive loops.
14. Photoelectric cell to open, close or automatically stop the barrier arm
15. Photoelectric cell support post
16. AS1321 Input/Output extension board CAN.
17. AS1049 board for third-party traffic signs.
18. Thermostatic 400W heating for operation down to -49°F [-45°C]
19. Red arm light.
20. Raised base.
21. Rotating base.
22. Isolation anti-corrosion base.
23. Other RAL colors available
24. Smart Touch monitoring and control panel.

^{(a)(b)} *Mutually incompatible options.*

^(c) *When equipped with these options the barrier is not ETL listed.*

For restrictions on options please speak to your sales representative.